

## BATTERY CONSTRUCTION [LF]

B3E011701008T05

- Air that passes through the battery duct when the vehicle is moving is used to cool the battery, preventing battery degradation from the heat made by chemical reaction, improving reliability.

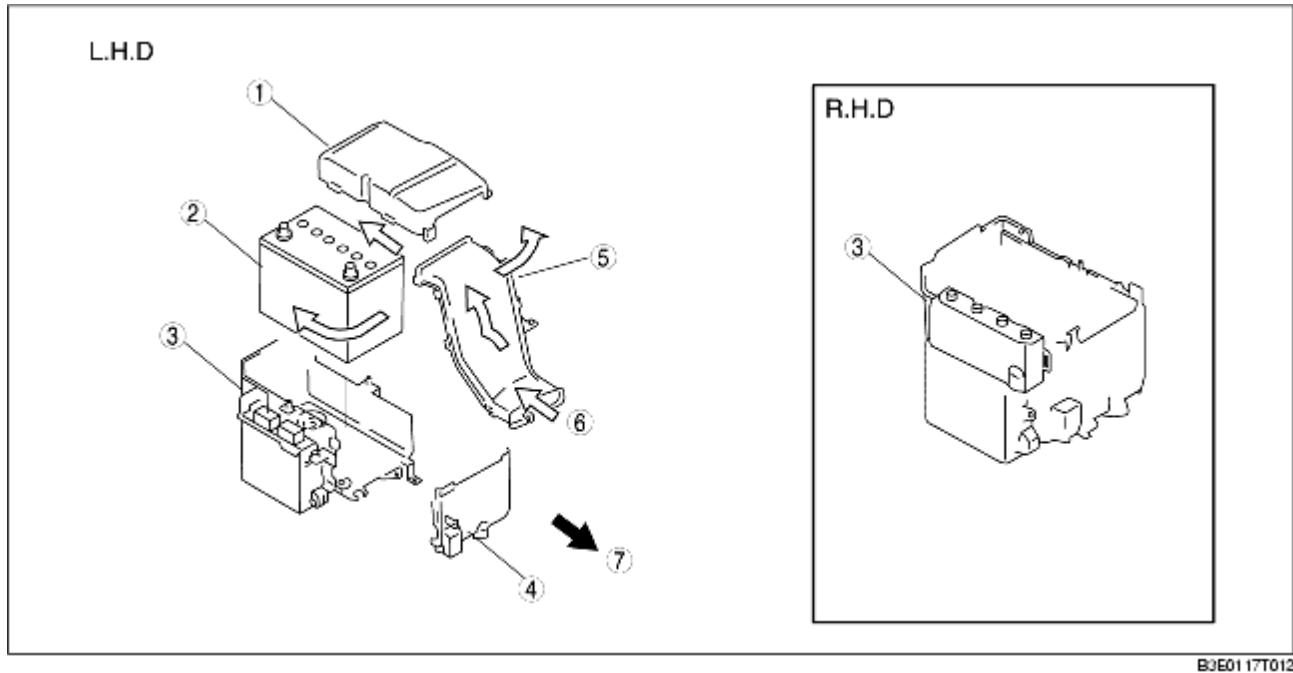

1	Battery cover
2	Battery
3	Battery tray
4	Battery box
5	Battery duct
6	Intake air
7	Front